

**Anexo Infraestructura Vial (Parte 2)**

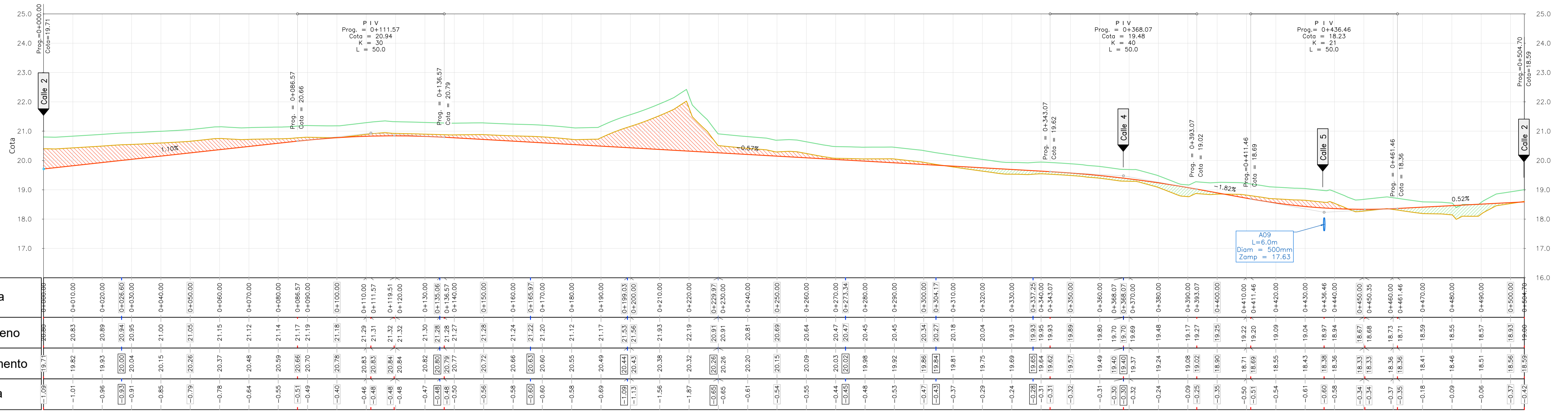

Progresiva	Cota de Terreno	Cota de Pavimento	Cota Roja
0+000.00	20.83	19.82	-1.01
0+010.00	20.89	19.93	-0.96
0+020.00	20.94	20.04	-0.91
0+030.00	21.00	20.15	-0.85
0+040.00	21.05	20.26	-0.79
0+050.00	21.11	20.37	-0.74
0+060.00	21.12	20.48	-0.64
0+070.00	21.14	20.59	-0.55
0+080.00	21.17	20.66	-0.51
0+090.00	21.19	20.70	-0.49
0+100.00	21.18	20.78	-0.40
0+110.00	21.29	20.83	-0.46
0+120.00	21.31	20.83	-0.48
0+130.00	21.32	20.84	-0.48
0+140.00	21.32	20.84	-0.48
0+150.00	21.30	20.82	-0.47
0+160.00	21.28	20.80	-0.48
0+170.00	21.27	20.79	-0.48
0+180.00	21.27	20.77	-0.50
0+190.00	21.28	20.72	-0.56
0+200.00	21.24	20.66	-0.58
0+210.00	21.22	20.63	-0.59
0+220.00	21.20	20.60	-0.60
0+230.00	21.19	20.59	-0.60
0+240.00	21.18	20.58	-0.60
0+250.00	21.17	20.57	-0.60
0+260.00	21.17	20.57	-0.60
0+270.00	21.17	20.57	-0.60
0+280.00	21.17	20.57	-0.60
0+290.00	21.17	20.57	-0.60
0+300.00	21.17	20.57	-0.60
0+310.00	21.17	20.57	-0.60
0+320.00	21.17	20.57	-0.60
0+330.00	21.17	20.57	-0.60
0+340.00	21.17	20.57	-0.60
0+350.00	21.17	20.57	-0.60
0+360.00	21.17	20.57	-0.60
0+370.00	21.17	20.57	-0.60
0+380.00	21.17	20.57	-0.60
0+390.00	21.17	20.57	-0.60
0+400.00	21.17	20.57	-0.60
0+410.00	21.17	20.57	-0.60
0+420.00	21.17	20.57	-0.60
0+430.00	21.17	20.57	-0.60
0+440.00	21.17	20.57	-0.60
0+450.00	21.17	20.57	-0.60
0+460.00	21.17	20.57	-0.60
0+470.00	21.17	20.57	-0.60
0+480.00	21.17	20.57	-0.60
0+490.00	21.17	20.57	-0.60
0+500.00	21.17	20.57	-0.60

Calle 3

Escala horizontal = 1:750  
Escala vertical = 1:75

NUMERO	INICIO	FINAL	LONG./DES.	RADIO
C56	X:597619.015 Y:6151472.167 O+026.60	X:597630.288 Y:6151390.492 O+135.06	108.46	43.48
C57	X:597630.288 Y:6151390.492 O+135.06	X:597656.247 Y:6151374.950 O+165.97	30.91	43.85
C58	X:597656.247 Y:6151374.950 O+165.97	X:597686.105 Y:6151369.336 O+189.03	33.06	23.42
C59	X:597686.105 Y:6151369.336 O+189.03	X:597715.992 Y:6151374.372 O+229.97	30.95	43.86
C60	X:597715.992 Y:6151374.372 O+229.97	X:597788.370 Y:6151371.417 O+304.17	30.83	43.50
C61	X:597788.370 Y:6151371.417 O+304.17	X:597818.228 Y:6151365.802 O+337.25	33.08	23.34
C62	X:597818.228 Y:6151365.802 O+337.25	X:597844.114 Y:6151350.279 O+368.07	30.83	43.50

NUMERO	INICIO	FINAL	LONG./DES.	RADIO
C63	X:597844.114 Y:6151350.279 O+368.07	X:597860.220 Y:6151435.775 O+504.70	136.63	43.50
L20	X:597860.220 Y:6151435.775 O+504.70	X:597619.015 Y:6151472.167 O+026.60	26.60	
L21	X:597619.015 Y:6151472.167 O+026.60	X:597715.992 Y:6151374.372 O+229.97	43.37	

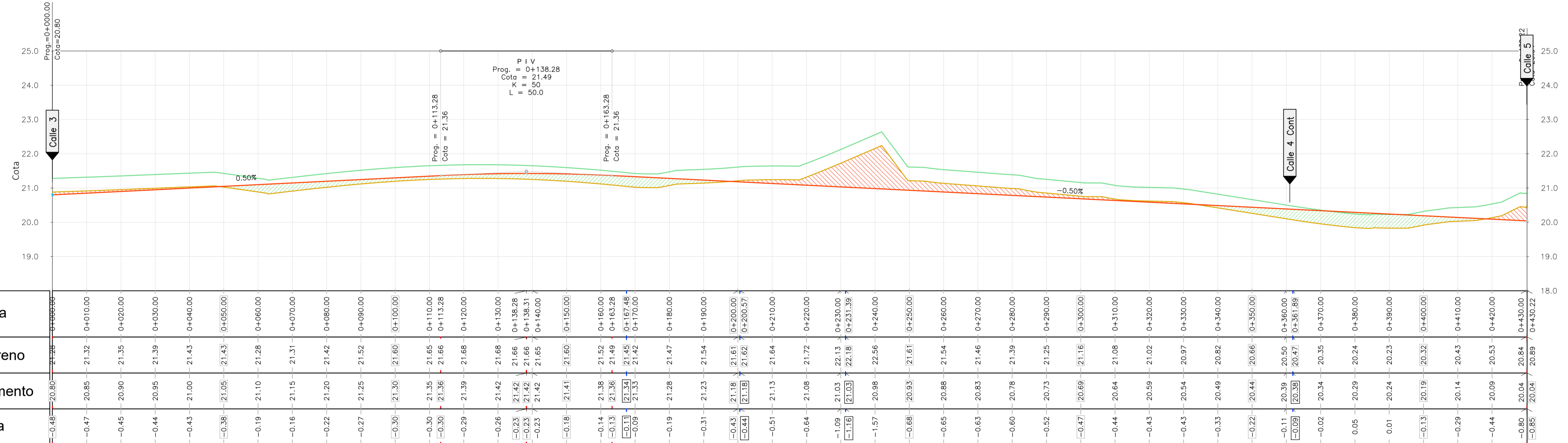

Progresiva	Cota de Terreno	Cota de Pavimento	Cota Roja
0+000.00	21.32	20.80	-0.52
0+010.00	21.35	20.85	-0.50
0+020.00	21.39	20.90	-0.49
0+030.00	21.43	20.95	-0.48
0+040.00	21.45	21.00	-0.45
0+050.00	21.43	21.05	-0.38
0+060.00	21.28	21.10	-0.19
0+070.00	21.31	21.15	-0.16
0+080.00	21.42	21.20	-0.22
0+090.00	21.52	21.25	-0.27
0+100.00	21.60	21.30	-0.30
0+110.00	21.65	21.35	-0.30
0+120.00	21.66	21.36	-0.30
0+130.00	21.68	21.39	-0.29
0+140.00	21.68	21.42	-0.26
0+150.00	21.68	21.45	-0.23
0+160.00	21.66	21.48	-0.14
0+170.00	21.66	21.51	-0.13
0+180.00	21.65	21.54	-0.11
0+190.00	21.65	21.57	-0.09
0+200.00	21.62	21.60	-0.08
0+210.00	21.64	21.63	-0.09
0+220.00	21.72	21.68	-0.04
0+230.00	21.72	21.72	-0.00
0+240.00	21.72	21.72	-0.00
0+250.00	21.72	21.72	-0.00
0+260.00	21.72	21.72	-0.00
0+270.00	21.72	21.72	-0.00
0+280.00	21.72	21.72	-0.00
0+290.00	21.72	21.72	-0.00
0+300.00	21.72	21.72	-0.00
0+310.00	21.72	21.72	-0.00
0+320.00	21.72	21.72	-0.00
0+330.00	21.72	21.72	-0.00
0+340.00	21.72	21.72	-0.00
0+350.00	21.72	21.72	-0.00
0+360.00	21.72	21.72	-0.00
0+370.00	21.72	21.72	-0.00
0+380.00	21.72	21.72	-0.00
0+390.00	21.72	21.72	-0.00
0+400.00	21.72	21.72	-0.00
0+410.00	21.72	21.72	-0.00
0+420.00	21.72	21.72	-0.00
0+430.00	21.72	21.72	-0.00
0+440.00	21.72	21.72	-0.00
0+450.00	21.72	21.72	-0.00
0+460.00	21.72	21.72	-0.00
0+470.00	21.72	21.72	-0.00
0+480.00	21.72	21.72	-0.00
0+490.00	21.72	21.72	-0.00
0+500.00	21.72	21.72	-0.00

Calle 4

Escala horizontal = 1:750  
Escala vertical = 1:75

NUMERO	INICIO	FINAL	LONG./DES.	RADIO
C64	X:597630.361 Y:6151390.474 O+000.00	X:597644.040 Y:6151310.033 O+167.48	167.48	43.50
C65	X:597644.040 Y:6151310.033 O+167.48	X:597673.897 Y:6151304.418 O+200.57	33.08	23.34
C66	X:597673.897 Y:6151304.418 O+200.57	X:597699.784 Y:6151288.895 O+231.39	30.83	43.50
C67	X:597699.784 Y:6151288.895 O+231.39	X:597828.036 Y:6151264.777 O+361.89	68.33	43.50
L22	X:597828.036 Y:6151264.777 O+361.89	X:597844.114 Y:6151350.279 O+368.07	130.50	

Referencias

- Zona de desmote
- Zona de terraplén

LOS HORNEROS  
ANTEPROYECTO DE CALLES

Perfiles Longitudinales  
Calles 3 y 4

PROYECTISTA: Ing. Diego coiro  
por IMC  
FECHA: MAYO 2019

03

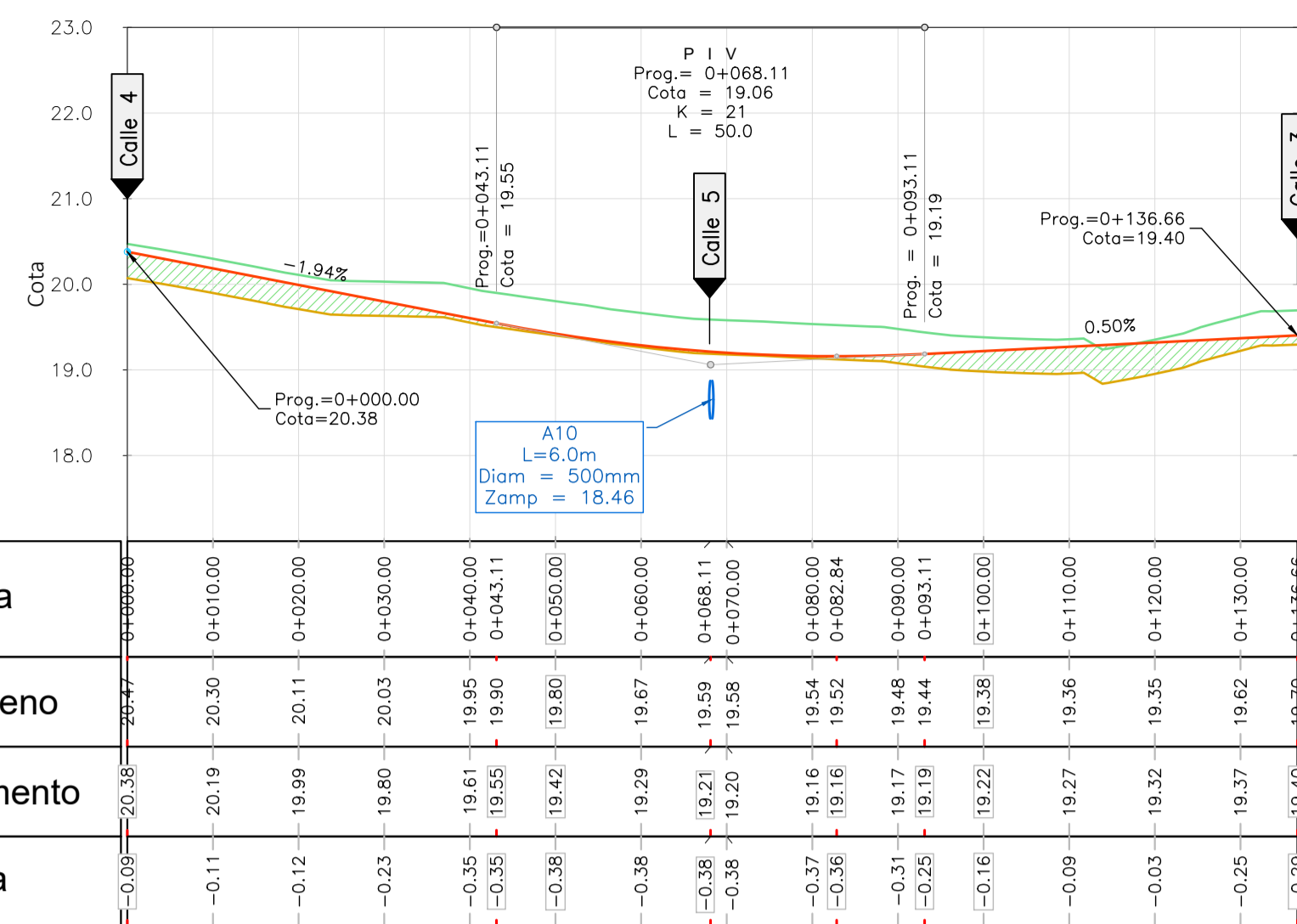

Progresiva	Cota de Terreno	Cota de Pavimento	Cota Roja
0+000.00	20.30	20.38	-0.08
0+010.00	20.11	20.19	-0.08
0+020.00	20.03	20.11	-0.08
0+030.00	19.95	20.03	-0.08
0+040.00	19.90	19.95	-0.05
0+043.11	19.80	19.55	-0.35
0+050.00	19.67	19.42	-0.38
0+060.00	19.59	19.29	-0.38
0+068.11	19.59	19.21	-0.38
0+070.00	19.54	19.20	-0.38
0+080.00	19.52	19.16	-0.37
0+082.84	19.44	19.16	-0.36
0+090.00	19.44	19.17	-0.31
0+093.11	19.38	19.19	-0.25
0+100.00	19.36	19.22	-0.16
0+110.00	19.35	19.27	-0.09
0+120.00	19.32	19.32	-0.03
0+130.00	19.62	19.37	-0.25
0+136.66	19.40	19.40	-0.29

Calle 4 Cont

Escala horizontal = 1:750  
Escala vertical = 1:75

CALLE 4 CONT				
NUMERO	INICIO	FINAL	LONG./DES.	RADIO
C68	X:597828.036 Y:6151264.777 0+000.00	X:597844.114 Y:6151350.279 0+136.66	136.66	43.50

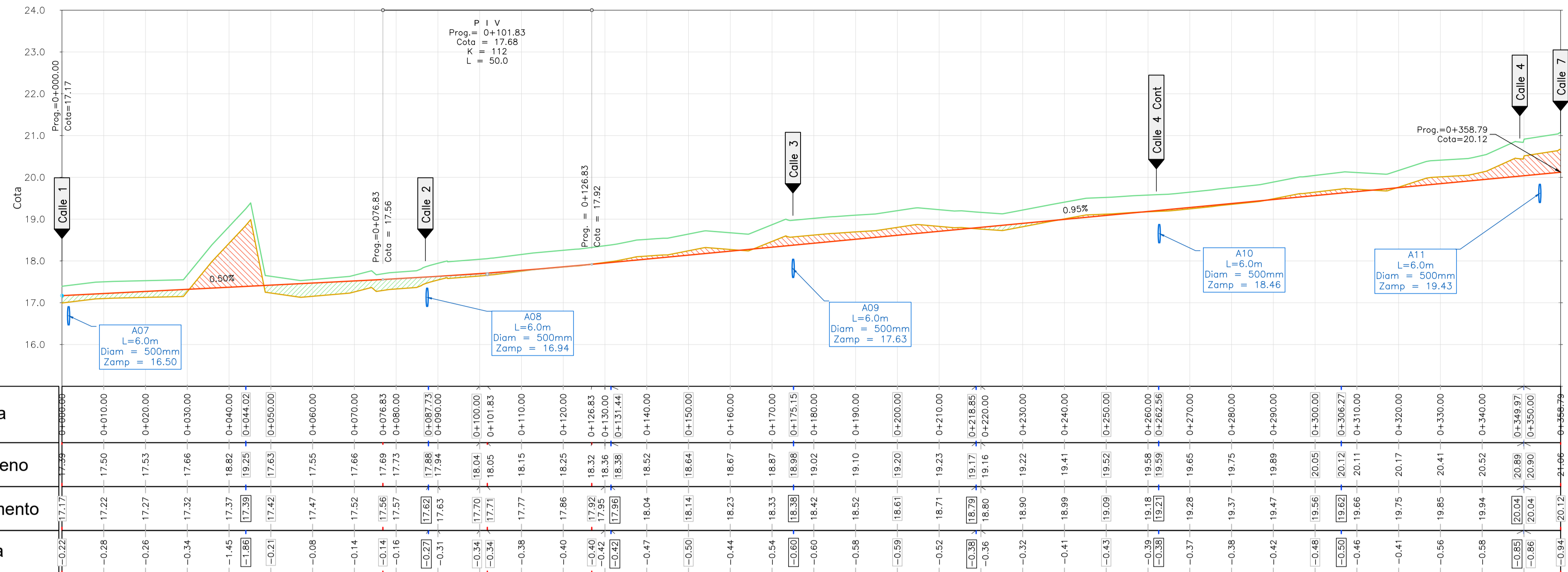

Progresiva	Cota de Terreno	Cota de Pavimento	Cota Roja
0+000.00	17.50	17.50	-0.22
0+010.00	17.50	17.22	-0.28
0+020.00	17.53	17.27	-0.26
0+030.00	17.66	17.32	-0.34
0+040.00	18.82	17.37	-1.45
0+044.02	19.25	17.39	-1.86
0+050.00	17.63	17.42	-0.21
0+060.00	17.55	17.47	-0.08
0+070.00	17.66	17.52	-0.14
0+076.83	17.69	17.56	-0.14
0+080.00	17.73	17.57	-0.16
0+087.73	17.88	17.62	-0.27
0+090.00	17.94	17.63	-0.31
0+100.00	18.04	17.70	-0.34
0+101.83	18.05	17.71	-0.34
0+110.00	18.15	17.77	-0.38
0+120.00	18.25	17.86	-0.40
0+126.83	18.32	17.92	-0.40
0+130.00	18.38	17.92	-0.46
0+131.44	18.38	17.96	-0.42
0+140.00	18.52	18.04	-0.47
0+150.00	18.64	18.15	-0.50
0+160.00	18.67	18.23	-0.44
0+170.00	18.87	18.33	-0.54
0+175.15	18.98	18.39	-0.60
0+180.00	19.02	18.42	-0.60
0+190.00	19.10	18.52	-0.58
0+200.00	19.20	18.63	-0.59
0+210.00	19.23	18.71	-0.52
0+220.00	19.16	18.79	-0.39
0+226.85	19.16	18.80	-0.36
0+230.00	19.22	18.90	-0.32
0+240.00	19.41	18.99	-0.41
0+250.00	19.52	19.09	-0.43
0+260.00	19.58	19.18	-0.39
0+262.56	19.59	19.23	-0.38
0+270.00	19.65	19.28	-0.37
0+280.00	19.75	19.37	-0.38
0+290.00	19.89	19.47	-0.42
0+300.00	20.05	19.56	-0.45
0+306.27	20.12	19.62	-0.50
0+310.00	20.11	19.66	-0.46
0+320.00	20.17	19.75	-0.41
0+330.00	20.41	19.85	-0.56
0+340.00	20.52	19.94	-0.58
0+349.97	20.89	20.04	-0.85
0+350.00	20.90	20.04	-0.86
0+358.79	20.12	20.12	-0.94

Calle 5

Escala horizontal = 1:750  
Escala vertical = 1:75

CALLE 5				
NUMERO	INICIO	FINAL	LONG./DES.	RADIO
L23	X:597927.118 Y:6151556.306	X:597923.198 Y:6151512.457	44.02	
L24	X:597923.198 Y:6151512.457 0+044.02	X:597910.982 Y:6151470.492 0+087.73	43.71	
L25	X:597910.982 Y:6151470.492 0+087.73	X:597907.120 Y:6151426.956 0+131.44	43.71	
L26	X:597907.120 Y:6151426.956 0+131.44	X:597894.904 Y:6151384.991 0+175.15	43.71	
L27	X:597894.904 Y:6151384.991 0+175.15	X:597891.042 Y:6151341.454 0+218.85	43.71	
L28	X:597891.042 Y:6151341.454 0+218.85	X:597878.826 Y:6151299.489 0+262.56	43.71	
L29	X:597878.826 Y:6151299.489 0+262.56	X:597874.984 Y:6151255.953 0+306.27	43.71	
L30	X:597874.984 Y:6151255.953 0+306.27	X:597862.748 Y:6151213.987 0+349.97	43.71	
L31	X:597862.748 Y:6151213.987 0+349.97	X:597861.118 Y:6151205.321 0+358.79	8.82	

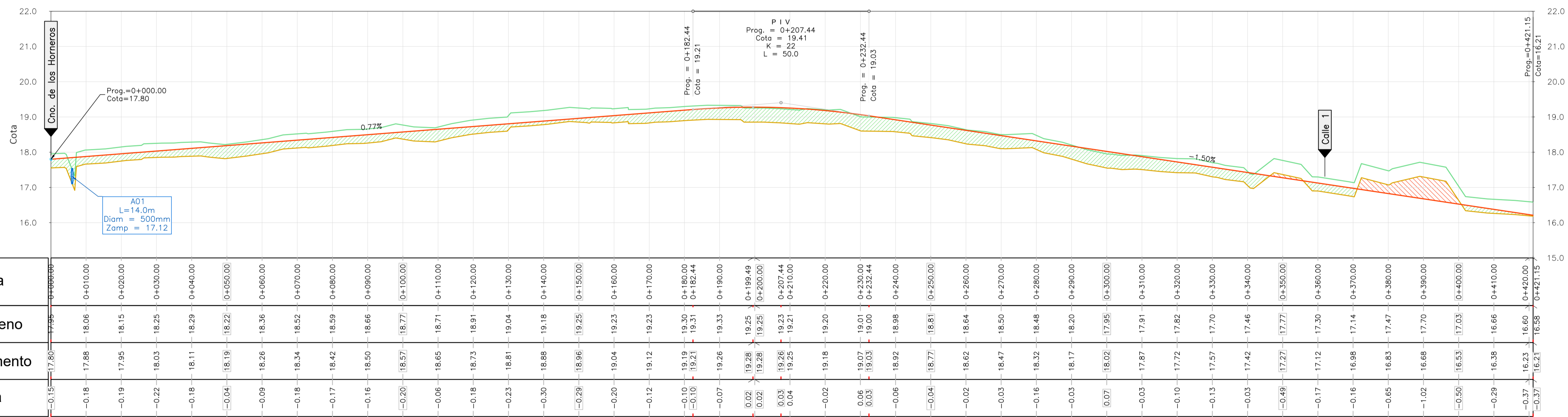

Progresiva	Cota de Terreno	Cota de Pavimento	Cota Roja
0+000.00	18.06	17.80	-0.15
0+010.00	18.15	17.88	-0.18
0+020.00	18.25	17.95	-0.19
0+030.00	18.29	18.03	-0.22
0+040.00	18.29	18.11	-0.18
0+050.00	18.22	18.19	-0.04
0+060.00	18.36	18.26	-0.09
0+070.00	18.52	18.34	-0.18
0+080.00	18.59	18.42	-0.17
0+090.00	18.66	18.50	-0.16
0+100.00	18.71	18.57	-0.20
0+110.00	18.71	18.65	-0.06
0+120.00	18.91	18.73	-0.18
0+130.00	19.04	18.81	-0.23
0+140.00	19.18	18.88	-0.30
0+150.00	19.25	18.96	-0.29
0+160.00	19.23	19.04	-0.20
0+170.00	19.23	19.12	-0.12
0+180.00	19.30	19.19	-0.10
0+182.44	19.31	19.21	-0.10
0+190.00	19.33	19.26	-0.07
0+199.49	19.25	19.28	0.02
0+200.00	19.25	19.28	0.02
0+207.44	19.23	19.26	0.03
0+210.00	19.21	19.25	0.04
0+220.00	19.20	19.18	-0.02
0+230.00	19.01	19.07	0.06
0+232.44	19.00	19.03	0.03
0+240.00	18.98	18.92	-0.06
0+250.00	18.81	18.77	-0.04
0+260.00	18.64	18.62	-0.02
0+270.00	18.50	18.47	-0.03
0+280.00	18.48	18.32	-0.16
0+290.00	18.20	18.17	-0.03
0+300.00	17.95	18.02	0.07
0+310.00	17.91	17.87	-0.03
0+320.00	17.82	17.72	-0.10
0+330.00	17.70	17.57	-0.13
0+340.00	17.46	17.42	-0.03
0+350.00	17.77	17.27	-0.49
0+360.00	17.30	17.12	-0.17
0+370.00	17.14	16.98	-0.16
0+380.00	17.47	16.83	-0.65
0+390.00	17.70	16.68	-1.02
0+400.00	17.03	16.53	-0.50
0+410.00	16.66	16.38	-0.29
0+420.00	16.60	16.23	-0.37
0+421.15	16.58	16.21	-0.37

Calle 6

Escala horizontal = 1:750  
Escala vertical = 1:75

CALLE 6				
NUMERO	INICIO	FINAL	LONG./DES.	RADIO
L32	X:597571.739 Y:6151631.459 0+000.00	X:597985.632 Y:6151553.628 0+421.15	421.15	

Referencias

- Zona de desmonte
- Zona de terraplén

LOS HORNEROS

ANTEPROYECTO DE CALLES

Perfiles Longitudinales

Calles 4 Cont, 5 y 6

Perfil Tipo PT1 - Calle 7

Escala H:1:50 - V:1:25

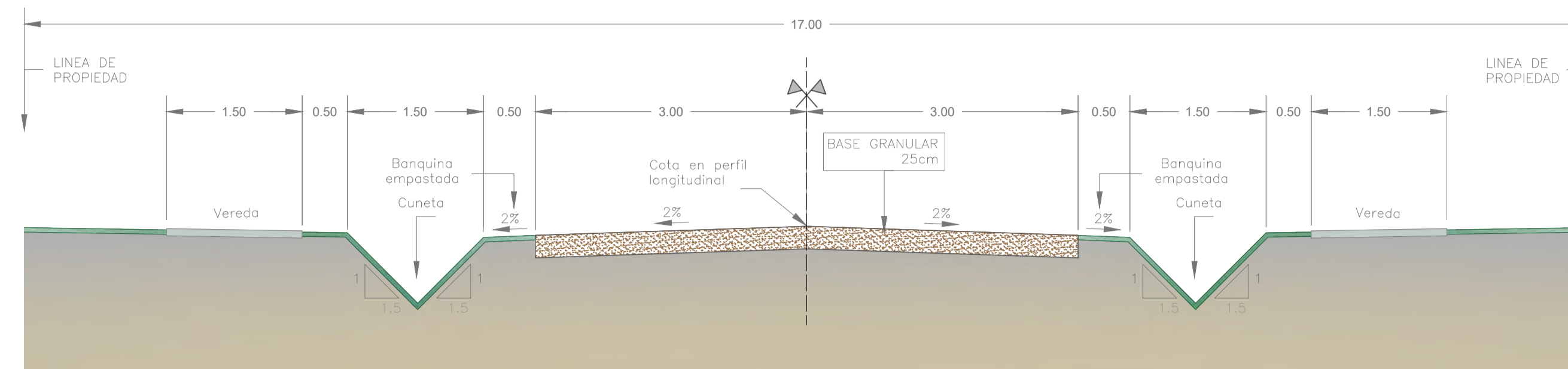

Perfil Tipo PT3 (Interno a la PH)

Escala H:1:50 - V:1:25

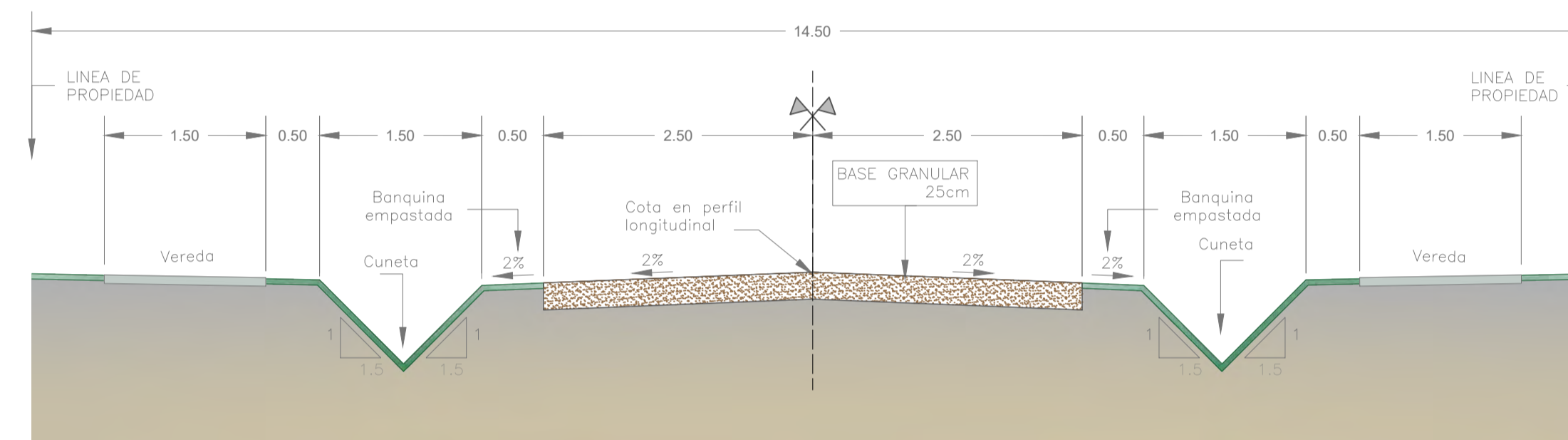

Perfil Tipo PT2 - Calle 6

Escala H:1:50 - V:1:25

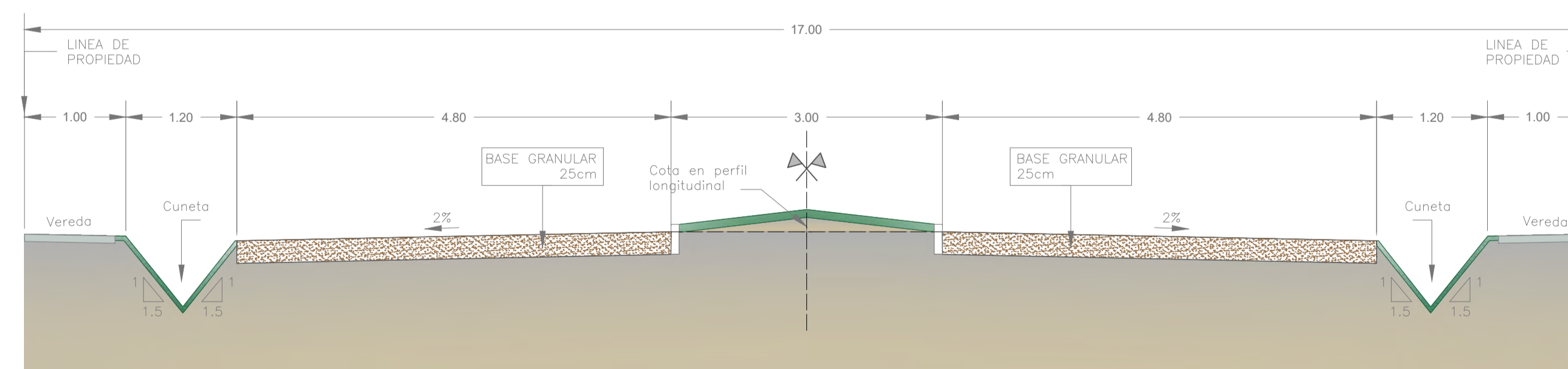

LOS HORNEROS

ANTEPROYECTO DE CALLES

Perfiles Tipo

PROYECTISTA:

Ing. Diego coiro

por IMC

FECHA:

MAYO 2019

05

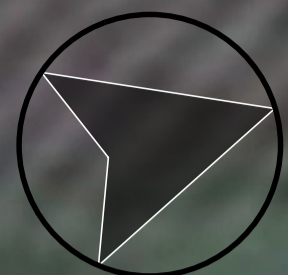

NORTE

CAMINO DE LOS HORNEROS

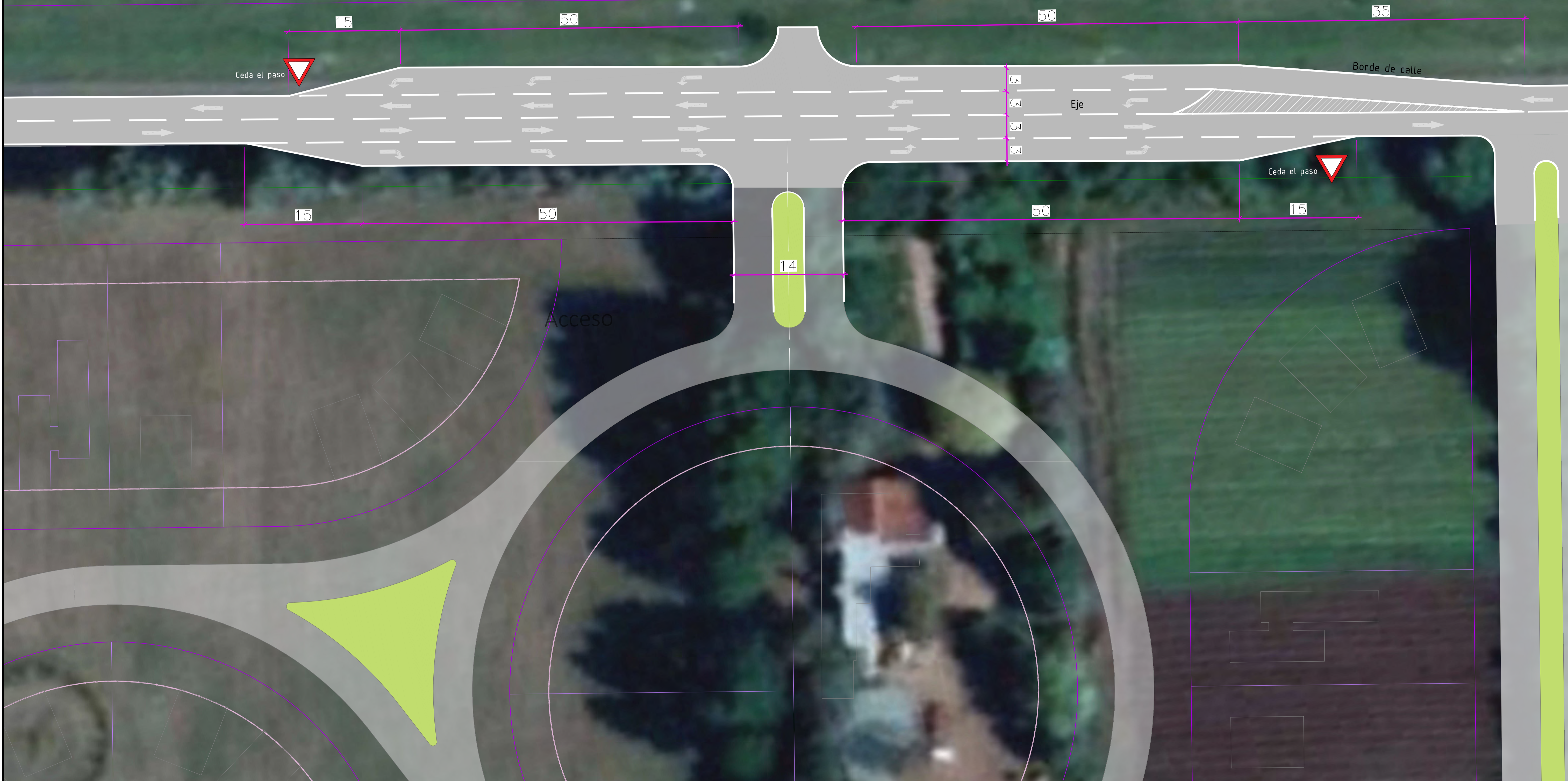

# LOS HORNEROS

ANTEPROYECTO DE CALLES

## Diseño de Acceso

PROYECTISTA:	por IMC	FECHA:	06
Ing. Diego coiro		MAYO 2019	